

LED TRAFFIC ADVISOR OPERATING INSTRUCTION



Specification:

- ▶ Operating Voltage: DC 12-24V
- ▶ LED Power: 1.5W/LED
- ▶ Flash Pattern: 27
- ▶ IP Rating: IP67
- ▶ Operating Temperature: -30°C to +60°C
- ▶ Approval: ECE R10, ECE R65 XA1(Amber LED Clear lens), CE, UKCA. Meet: SAE J595 Class 1 (Amber LED), CISPR 25 class 3.
- ▶ Reverse polarity protection.
- ▶ With memory function.
- ▶ Multiple units are synchronizable.
- ▶ Available for single color and dual color.
- ▶ Various wiring connection options available depending on users' need.
- ▶ The cable can be extended according to customer's need.
- ▶ Installation: bracket with magnet, only bracket (standard), or bracket with suction cup.

⚠ It is mandatory to use ECE R65 certified flash patterns on public roads, while other flash patterns can be used only when it is permitted.

Flash pattern:

| | |
|--|---|
| #1 Single flash - Half to half (ECE R65) | #15 Double flash - Half to half (ECE R65) |
| #2 Quad flash - Half to half (ECE R65) | #16 Half to half + All |
| #3 Left arrowstick | #17 Single flash + Quad flash |
| #4 Left constant flash | #18 One - one eight flash (fast) |
| #5 Right arrowstick | #19 One - one single flash |
| #6 Right constant flash | #20 One - one single flash - Split accelerate |
| #7 Middle to side arrowstick | #21 Center - out quad flash (perfect performance when 6 or 8 modules) |
| #8 Middle to side constant flash | #22 Center - out flash (split accelerate) |
| #9 Single flash (High light) | #23 End octa flash- Half to half (perfect performance when 6 or 8 modules, while 2,3,4 and 5 modules don't flash) |
| #10 Single flash (Low light) (ECE R65) | #24 Out - steady on, Center - double flash (perfect performance when 6 or 8 modules) |
| #11 Double flash (ECE R65) | #25 One - steady on, one - single flash |
| #12 Quad flash (ECE R65) | #26 Cycle |
| #13 Octa flash | #27 Steady on |
| #14 Single flash - Split accelerate | |

Mounting options:

Mounting for bracket (standard)

1. Put the bar on a flat surface, and install the mounting brackets on the back with the hardware as shown.
2. Place the bar in the selected location, and mark the hole locations. Adjust the mounting brackets as necessary.
3. Drill holes for mounting hardware (user supplied).
4. Install the bar with the hardware and attach them firmly so that it cannot be moved or lost.

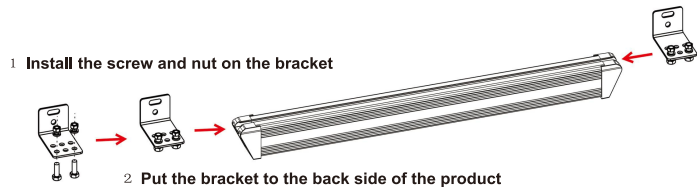

Size:

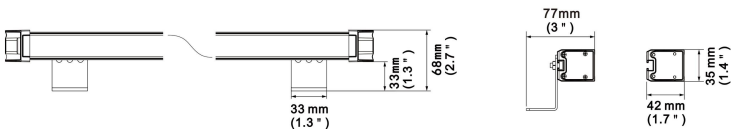

Mounting for bracket with suction cup:

1. Install the suction cup on the "U" bracket.
2. Put the 2 brackets together via screws, and install screws and nuts.
3. Put the total bracket to the back side of the bracket.
4. Adjust the position of brackets as necessary, tighten it via spanner.
5. Mounting the bar on a flat surface of the vehicle via suction cup, draining the air of the suction cup to make it strongly attracted to the surface.

Mark: bracket with suction cup only available for single row and it need to be purchased separately.

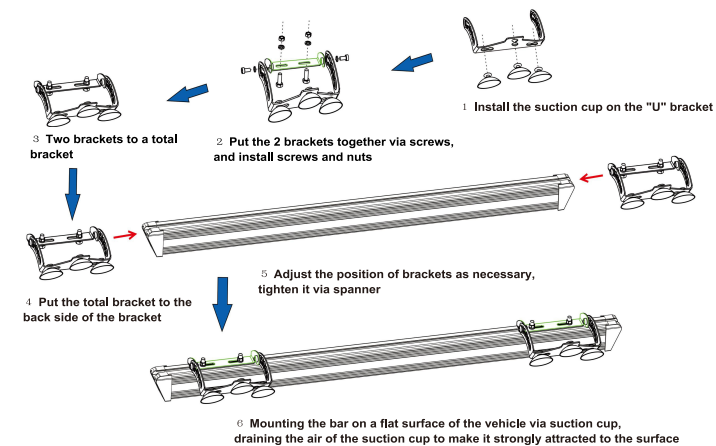

Drawing:

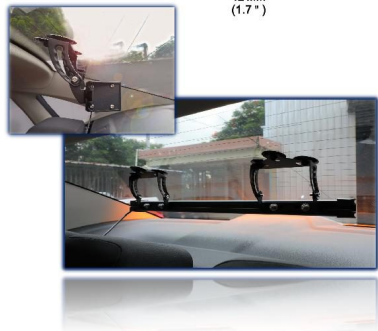
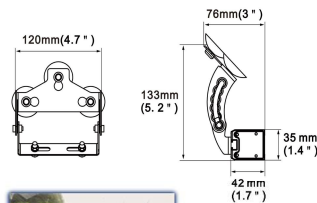

Wiring options (Four Types) :

1. Controller:

| | |
|------------------|------------------------------|
| ON/OFF (Power) | Left arrowstick |
| Previous pattern | Middle to side arrowstick |
| Next pattern | Right arrowstick |
| Day/Night mode | Steady on |
| Color option | ON/OFF (An auxiliary device) |



Controller

Standard adapter cable with 4 wires

Standard adapter cable - When with controller

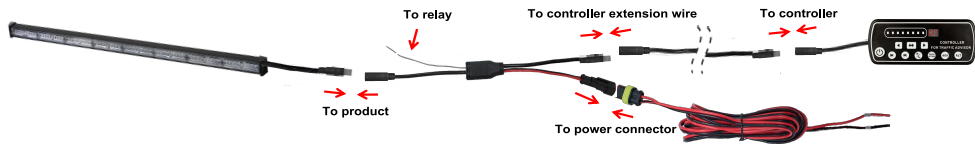

How to use the relay:

The current of this device should not exceed 30A.
Press the "ALT" button of the controller box can switch on an auxiliary device such as a strobe light, warning beacon, worklamp etc...
The relay wire connection as below :
1.Connect the bar red wire to relay contact 87, and aux device's to contact 30 ;
2.Place bar's and aux device's black wires together, and then connect to contact 86;
3.Connect the grey wire which is from controller to contact 85;
4.Turn on the whole equipment by connecting the power (+) to contact 87, and the power (-) to contact 86.



2. Cigar plug:

- Power On/Off
 - Pattern, dimming & color selector:
- (1) Pattern selection:
.....Less than 1second, next pattern;
.....More than 5 seconds, turn off; power on again back to the pattern before turning off.
 - (2) Single color dimming (cycling) :
.....Press 3-5 seconds, low intensity; 3-5 seconds again back to high intensity.
 - (3) Dual color dimming (cycling) :
.....Press 1-3 seconds, low intensity; 1-3 seconds again back to high intensity.
 - (4) Color selection (cycling) :
.....Press 3-5 seconds to Color#2; 3-5 seconds again alternate color#1 and #2; 3-5 seconds again back to color#1.



3. With 4 wires:

- Red:** + VDC
Black: - Ground
White: Synchronization, Connect white wires of all heads together for synchronization.
Yellow: Pattern, dimming & color selection (Apply to **Black wire**)
- (1) Pattern selection:
.....Less than 1second, next pattern;
.....More than 5 seconds, turn off;
power on again back to the pattern before turning off.
 - (2) Single color dimming (cycling) :
.....Press 3-5 seconds, low intensity; 3-5 seconds again back to high intensity.
 - (3) Dual color dimming (cycling) :
.....Press 1-3 seconds, low intensity; 1-3 seconds again back to high intensity.
 - (4) Color selection (cycling) :
.....Press 3-5 seconds to Color#2; 3-5 seconds again alternate color#1 and #2; 3-5 seconds again back to color#1.

4. With 7 wires (Straight cable 3.5m):

- Red:** + VDC
Black: - Ground
White: Synchronization, Connect white wires of all heads together for synchronization.
Yellow: Color and flash pattern selection (Apply to **Black wire**)
-Less than 1second for next pattern.
.....1-3 seconds for low intensity, press 1-3 seconds again back to normal intensity.
.....3-5 seconds for next color, another 3-5 seconds again for two colors alternate flash, another 3-5 seconds again back to first color, cycle operating like this (only available for dual color).
.....More than 5 seconds for turn off, when power is reapplied it will resume the previous pattern.
- Blue**(Apply to black wire constantly): traffic advisor pattern—middle to side arrowstick.
Brown(Apply to black wire constantly): traffic advisor pattern—from left to right.
Green(Apply to black wire constantly): traffic advisor pattern—from right to left.



Size & LED QTY:

| Module QTY | Size | | LED QTY | |
|------------|--------------|---------------|--------------|-------------|
| | L*W*H(mm) | L*W*H(in) | Single color | Dual color |
| 1 PCS | 196*42*35mm | 7.7*1.7*1.4" | 9LED*1.5W | 18LED*1.5W |
| 2 PCS | 340*42*35mm | 13.4*1.7*1.4" | 18LED*1.5W | 36LED*1.5W |
| 3 PCS | 484*42*35mm | 19.1*1.7*1.4" | 27LED*1.5W | 54LED*1.5W |
| 4 PCS | 628*42*35mm | 24.7*1.7*1.4" | 36LED*1.5W | 72LED*1.5W |
| 5 PCS | 772*42*35mm | 30.4*1.7*1.4" | 45LED*1.5W | 90LED*1.5W |
| 6 PCS | 916*42*35mm | 36.1*1.7*1.4" | 54LED*1.5W | 108LED*1.5W |
| 7 PCS | 1060*42*35mm | 41.7*1.7*1.4" | 63LED*1.5W | 126LED*1.5W |
| 8 PCS | 1204*42*35mm | 47.4*1.7*1.4" | 72LED*1.5W | 144LED*1.5W |

Drawing:

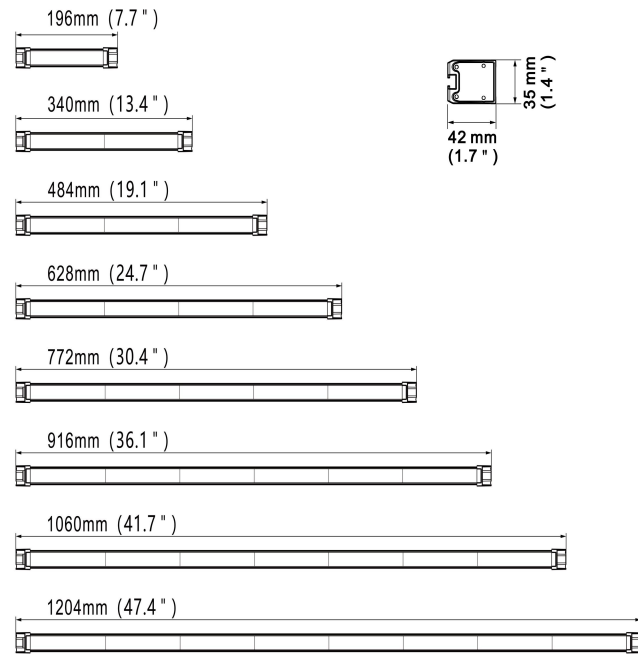

WARNING

- (1) Do not look directly into LEDs while in operation; may cause momentary blindness and/or eye damage.
- (2) It is not recommended to use magnetically mounted warning devices on vehicles in motion, suggest if need to use available bolt installation on vehicles in motion. Usage is at sole risk and responsibility of the user.
- (3) It is mandatory to use ECE R65 certified flash patterns on public roads; while other flash patterns can be used only when it is permitted.